

Continuous Cleat Plus Intermittent Clip with a Continuous Cleat

ORDER SPECIFICATION FORM

ANSI/SPRI/FM4435/ES-1 TEST PRESSURES UP TO 159 PSF (VERTICAL), AND 91 PSF (HORIZONTAL)

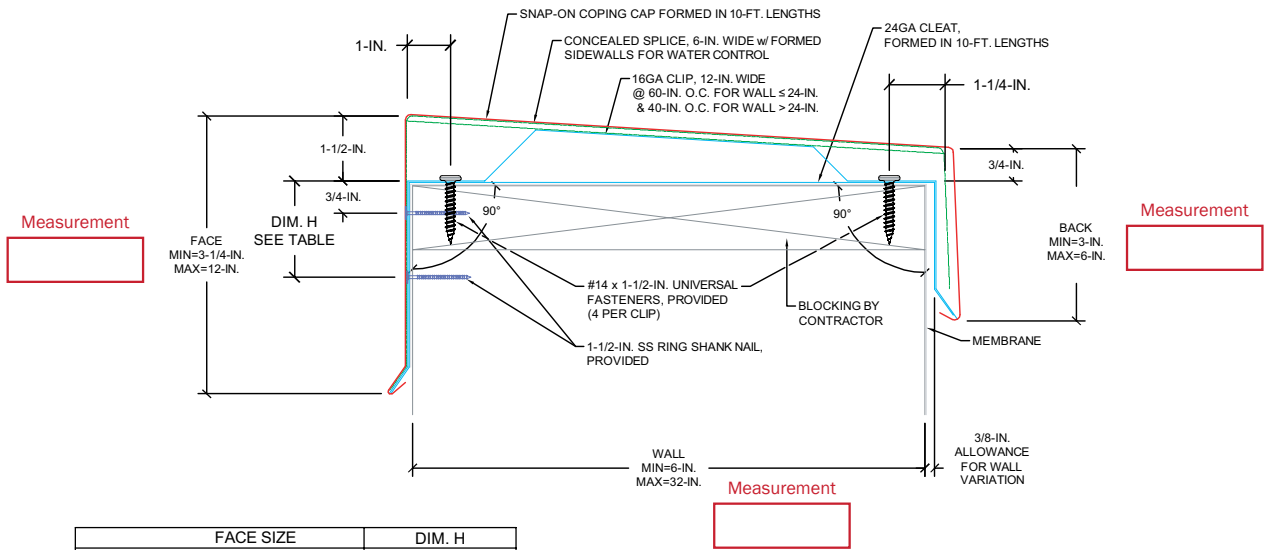

FACE SIZE	DIM. H
FACE < 4-3/4-IN.	3/4-IN.
4-3/4-IN. ≤ FACE ≤ 7-1/2-IN.	2-1/4-IN.
7-1/2-IN. < FACE ≤ 9-IN.	3-3/4-IN.
9-IN. < FACE ≤ 10-1/2-IN.	5-1/4-IN.
10-1/2-IN. < FACE ≤ 12-IN.	6-3/4-IN.

FOR MASONRY APPLICATIONS, PLEASE CONTACT US.
CONTACT US FOR APPROPRIATE RECOMMENDATIONS NEEDED TO MEET/EXCEED ANSI/SPRI/FM4435/ES-1 DESIGN CRITERIA

APPROVALS	COVER MATERIAL	THICKNESS	COVER FINISH
<div style="display: flex; justify-content: space-between; align-items: center;"> <div style="border: 1px solid black; padding: 2px;">ANSI/SPRI/FM 4435 /ES-1 TESTED</div> <div>Florida Product Approval</div> <div style="border: 1px solid black; padding: 2px; border-radius: 10px;">MIAMI-DADE COUNTY APPROVED</div> <div style="text-align: center;">CLASSIFIED UL</div> </div>	Aluminum Galvanized Steel Stainless Steel	24Ga. 22Ga. .040 in. .050 in. .063 in. .080 in.	Mill Prefinished Kynar Premium Prefinished Kynar Post Finished Kynar Prefinished Anodized Post Finished Anodized
QUANTITY Attach Sketches of Z- and T- Miters _____ Straight Length _____ Total Miters (Inside: _____ / Outside: _____) _____ Total End Caps (Left: _____ / Right: _____) _____ Total End Terms (Left: _____ / Right: _____) _____ Transition Miters _____ T-Miter _____ Z-Miter _____ Radius _____ Radius to Straight Miter _____ Radius End Cap _____ Vault Welded _____ Vault to Straight Miter Welded _____ Vault End Cap _____ Ridge Miter _____ Valley Miter	ACCESSORY TYPE Welded Metal-Lok	CUSTOMER APPROVAL <div style="display: flex; justify-content: space-around;"> Approved for Fabrication Approved with Changes Not Approved </div> _____ Authorized Customer Signature _____ Title Date	
COLOR _____	Project Location: Customer: Representative:		

Continuous Cleat Plus Intermittent Clip with a Continuous Cleat

ORDER SPECIFICATION FORM

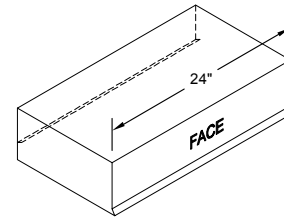
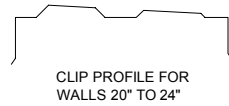
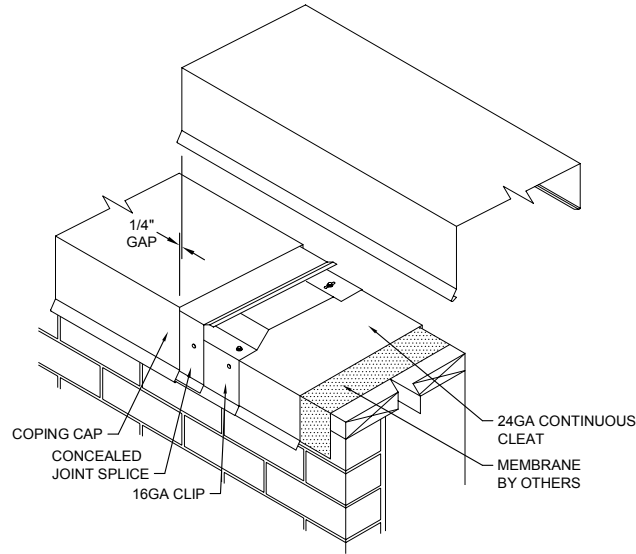

END CAP
LEFT HAND SHOWN

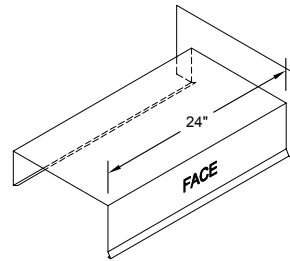
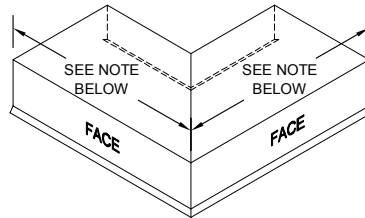
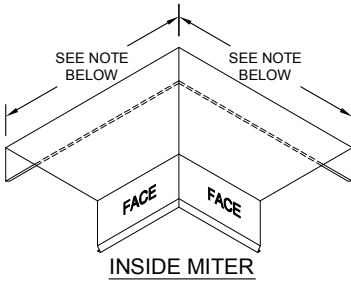

Standard coping miter leg lengths:
23 1/4-in. for 7 1/2-in. to 16-in. wall widths
29 1/4-in. 16-in. to 23-in. wall widths
custom lengths for wall widths > 23-in.
Standard coping miter angle is 90°
For special miter requirements, attach sketches or consult manufacturer for assistance.